



Cordless Riveter R2B1

Easy Guide

Thank you for purchasing the LOBSTER brand cordless riveter.

Instruction Manual

- The instruction manual is not included with the product. To ensure correct operation, please carefully read the Easy Guide (this manual) and the Instruction Manual available on the following Website and store them for later reference.
<https://www.lobtex.co.jp/english/products/tabid/153/pdId/E-R2B1/catid/108/Default.aspx>
- After reading this manual, keep it in a safe place together with the machine.



For smartphone

Introduction

- This tool is dedicated tool for blind rivet used to calk and tighten the LOBSTER brand rivets. This machine is not designed, manufactured, or sold for other usages.
- Use rivets with the specifications and strength for which you have fully conducted design discussion.

1 Easy Guide and Instruction Manual

The instructions for use of these tools are divided into this manual and instruction manual. Please refer to this manual or instruction manual according to the information you need.

Contents of Easy Guide

• Safety precautions • Part names • Serial No. • Set contents

Contents of Instruction Manual

• "Easy Guide (this document)" • Specifications • Preparation before use
• Work procedure • Points for maintenance and inspection • Troubleshooting
• Exploded diagram • Parts list • How to store • How to order parts

2 Important Notes

- Read this manual and Instruction Manual carefully before using this tool. Follow instructions in Instruction Manual for handling this tool, replacing accessories or replacing parts as needed.
- If you have any questions about this manual and Instruction Manual, contact the "LOBSTER" dealer where you purchased the tool.
- It is impossible to foresee all potential dangers and describe them in this manual and Instruction Manual. You must operate this tool paying attention to safety as well as observing the instructions in this manual and Instruction Manual.
- This manual and Instruction Manual are translated from Japanese, its original language. It is your own responsibility to achieve a full understanding of the contents of this manual and Instruction Manual before using the equipment described.
- Lobtex Co., Ltd. has the copyright of this manual and Instruction Manual. These are prohibited to publish, copy or translate to other language without prior consent.

3 Disclaimer

- We will not compensate for damage and profit loss directly or indirectly caused by misuse, abuse, unauthorized modification, etc. of this machine, nor guarantee the rivet including its strength.
- We will not be held liable in any way for any damage or problem caused by modification that is not approved by us in written form.
- We will not be held liable in any way for any damage or problem caused by use of parts other than the recommended parts.

LOBTEX CO.,LTD.

Call center Tel: +81-72-980-1111 Fax: +81-72-980-1166

12-8 Shijo-cho, Higashi-Osaka City,
Osaka 579-8053, Japan

Website <https://www.lobtex.co.jp/>
No.RCR2B1S02100

Names of components

Machine body (R2B1)

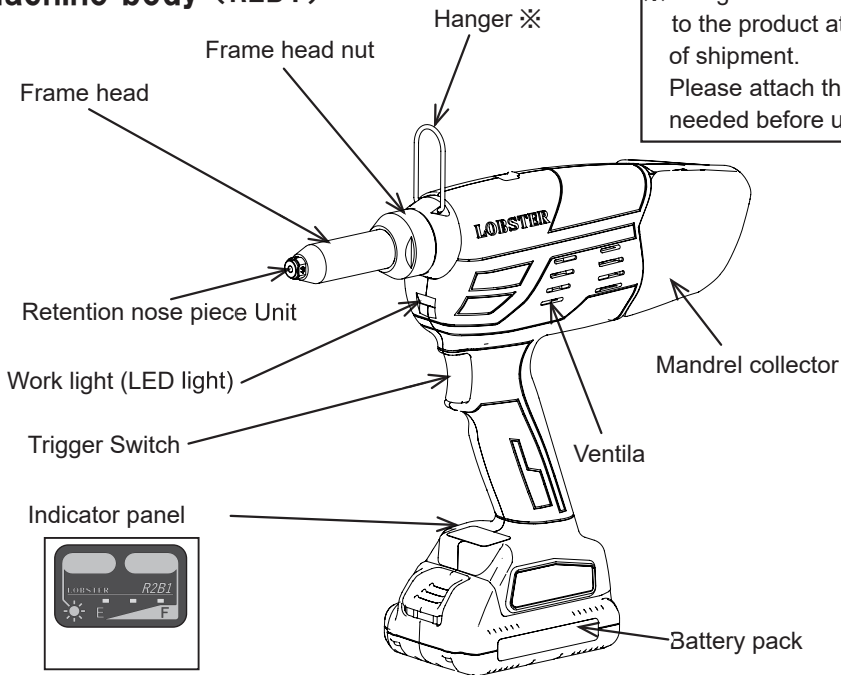

※ Hangers are not attached to the product at the time of shipment. Please attach them as needed before use.

Interior of frame head (R2B1)

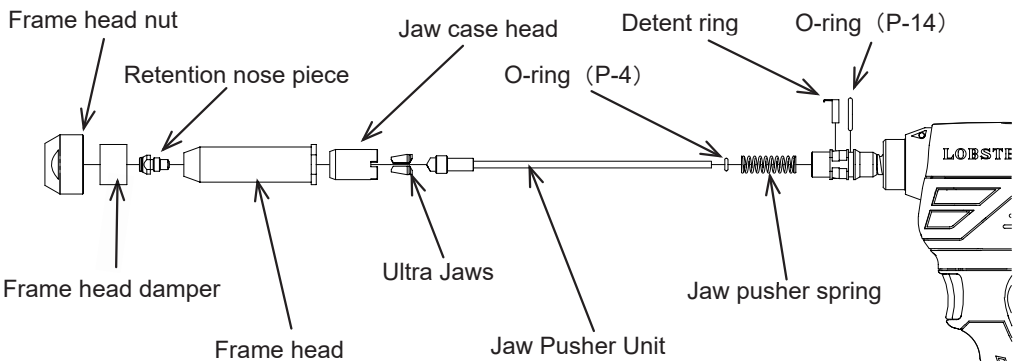

Serial No.

* The serial number of the cordless riveter body is displayed on the bottom of the body with 3 digits of alphabet and 5 digits of number.

How to view manufacturing year

Manufacturing year/month	1	2	3	4	5	6	7	8	9	10	11	12
Code	A	B	M	N	K	W	T	Y	U	O	L	Z

Example) 2 0 ② ③ Year ③ Month

↓
B

↓
M

↓
M

Serial number

⇒ BMMOOOOO

Battery pack

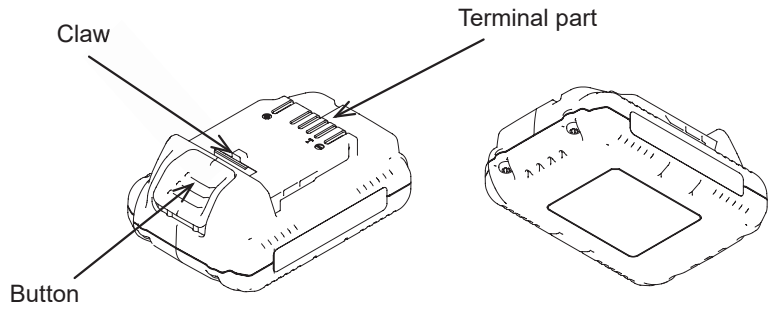

Battery Charger

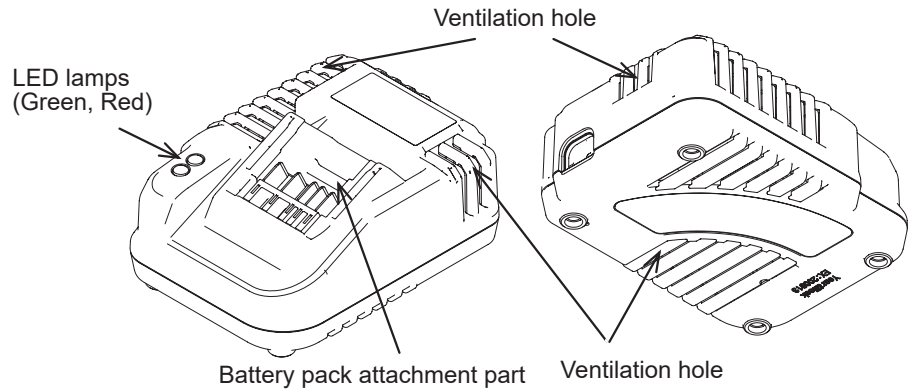

Power Cable

• Power Cable(For 120V)
(for North America)

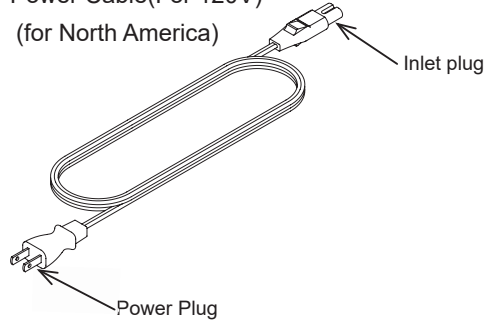

• Power Cable(For 230V)
(for Europe)

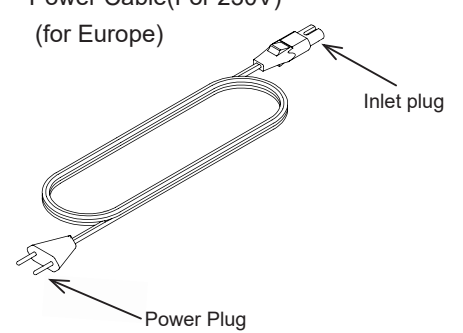

※ Cables corresponding to the model type are included.

Set Contents

Please make sure that all of the items listed below, including the cordless riveter body, are included in the dedicated blow case. We take all possible measures to ensure the packaging is complete, but if anything is missing, please contact the store where you purchased the product or our call center. Depending on the product, cautionary statements not listed below may be included in the package. Please refer to it when using or maintaining the product.

1. Cordless Riveter R2B1

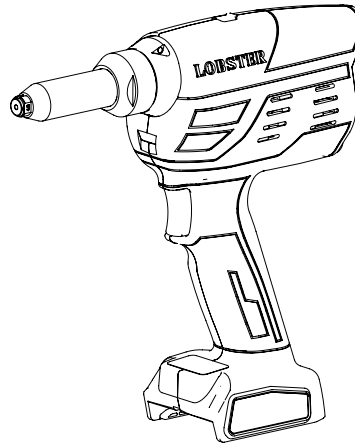

2. Mandrel collector

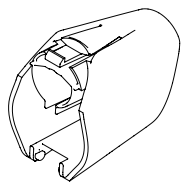

3. Battery pack

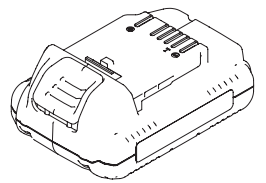

※ * The following items are attached to the main unit when the product is shipped.
• Retention nose pieceΦ4.8
• Jaw Pusher UnitΦ4.8

5. Jaw Pusher Unit

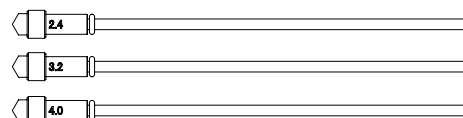

4. Retention nose piece Unit



6. Charger

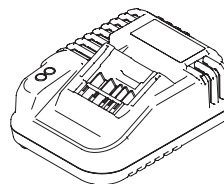

7. Power Cable(for120Vor230V)

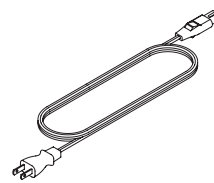

8. Lubricant Oil

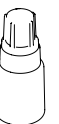

9. Hanger



10. Easy Guide (This manual) English,French 1ea



◆ Before using this machine, read all “Safety Precautions” below to fully understand them for the correct and safe use of this machine.

◆ During use of this machine, be sure to wear protective goggles. Failure to follow this instruction may cause you to get injured when the mandrel of a cut rivet springs out.

Description of signs	
<div><div></div><div>WARNING</div></div>	Indicates a potentially hazardous situation which, if ignored, may result in moderate injury to the operator or physical damage.
<div><div></div><div>CAUTION</div></div>	Indicates a potentially hazardous situation which, if ignored, may result in moderate injury to the operator or physical damage.

Note that even a matter categorized as

CAUTION

 may lead to a serious consequence. As instructions in both categories describe important matters, be sure to observe all the safety precautions.

◆ After reading this document, be sure to keep it at hand so that the user can refer to it anytime.

WARNING

Compulsory

1. During battery charging, if the charging is not completed even when the specified charging time has passed, stop charging.

• Consult the store where you purchased this machine or us. If charging is continued in this condition, an accident or injury may result.

2. If you have observed an abnormality of the battery pack, including an abnormal odor, heat generation, discoloration, and deformation, immediately stop the machine and take out the battery pack from this machine or charger.

• Consult the store where you purchased this machine or us. If you continue the use of this machine in this condition, an accident or injury may result.

3. Use this machine by connecting it to a power source with an indication of the rating.

• Do not use this machine by connecting it to a direct current source, an engine power generator, or a transformer or similar device such as potential transformer and booster. Failure to follow this instruction may case abnormal heat generation and fire.

4. Charge the battery pack at a well-ventilated location.

• Do not cover the battery pack or charger with cloth or the like during charging. Failure to follow this instruction may cause heat generation, smoke, and fire.

5. If an abnormality such as smoke and an abnormal odor has occurred during use of the charger, immediately stop using it and disconnect the power plug from the receptacle.

• Consult the store where you purchased this machine or us. Use of the charger in this condition may cause an accident or injury.

6. If the battery liquid leaks out or abnormal odor is produced, immediately stop using the machine and keep the battery away from fire.

• Consult the store where you purchased this machine or us.Use of the battery in this condition may cause an accident or injury.

7. Carefully handle the battery pack and charger.

• Do not drop the battery pack and charger, and do not give a strong shock to them. If the outer case is broken, do not use the battery pack or charger.Failure to follow this instruction may cause an electric shock, smoke, fire, bursting, or other accident.

• Do not disassemble or modify the battery pack and charger. Failure to follow this instruction may cause an electric shock, smoke, fire, bursting, or other accident.

• Failure to follow this instruction may cause an accident or injury.

8. If the battery liquid has leaked out, do not touch it with bare hands, but take the following actions.

• If the battery liquid gets into your eye, you could become visually impaired in one eye. In this case, do not rub your eye, but wash it immediately with clean water and then consult a doctor.

• If the battery liquid gets on your body or cloth, skin inflammation or injury may be caused. Sufficiently wash the liquid away with clean water and then consult a doctor.

• Stop using a battery pack from which the battery liquid has leaked out, and do not put it close to fire. Immediately consult the store where you purchased this machine.

9. Positively insert the power plug all the way.

• If insertion is insufficient, an electric shock or heat generation may cause fire. Do not use a damaged plug and a loose receptacle.

10. If an abnormality, such as malfunctioning, heat generation, smoke, or abnormal sound is observed during use, immediately take out the battery pack and stop using this machine.

• Consult the store where you purchased this machine or us. Use of the battery in this condition may cause an accident or injury.

WARNING

Compulsory

11. Use dedicated genuine parts only.

• Do not use parts other than the genuine parts that are listed in this document and our catalogues. Failure to follow this instruction may cause a serious accident or injury.

12. Take into consideration the circumstances surrounding the workshop as well.

• This prevents accidents and injuries.

13. Ensure the workshop is sufficiently lit.

• Work in a dark location may cause an accident or injury.

14. Always wear personal protective equipment and protective goggles.

• Appropriately use a dust protective mask, safety shoes, a helmet, earpieces, and others to prevent an accident or injury.

15. In replacement of a part or accessory, follow the specified procedures.

• If the specified procedures are not followed, a failure, an accident, or injury may occur.

16. Do not make inadvertent actions. When you are not working, do not touch the trigger switch with your finger or an object.

• Do not carry this machine by hooking your finger to a trigger switch. Failure to follow this instruction may cause this machine to unexpectedly start, possibly leading to an accident or injury.

17. When you do not use this machine or a risk is anticipated, turn off the switch on this machine and take out the battery pack from the machine body.

• Failure to follow this instruction may lead to an accident or injury when an unexpected action is made.

18. When conducting maintenance, inspection and part replacement, be sure to take out the battery pack.

• Failure to follow this instruction may lead to an accident or injury when an unexpected action is made.

19. If two or more battery packs are used in succession, stop this machine for about 15 minutes.

• Failure to follow this instruction may cause the temperature of the machine body to excessively rise, possibly leading to burns.

Prohibition

20. Do not charge the battery pack at an ambient temperature outside the charger operation temperature range.

• Failure to follow this instruction may disable correct charging and shorten the service life of the battery pack. Heat generation, smoke, fire, bursting, or other accident may also be caused.

21. Do not use a deteriorated battery pack.

• Failure to follow this instruction may case battery liquid leakage, electric shock, heat generation, smoke, fire, bursting, or other accident.

22. Do not immerse the battery pack in conductive liquid such as water. Do not let conductive liquid such as water enter the battery pack.

• If conductive liquid such as water enters the battery pack, short-circuiting occurs, possibly leading to heat generation, fire, or bursting.

23. Do not dispose of a used battery pack as household waste.

• Failure to follow this instruction may cause a disposed battery pack to be crushed inside a garbage truck and short-circuited, possibly leading to an accident such as fire.

24. Do not use this machine at a location where strong static electricity is generated.

• Failure to follow this instruction may cause an abnormal action, a liquid leakage, an electric shock, heat generation, smoke, fire, bursting, or other accident.

25. Do not use the battery with its polarities (+, –) reversed.

• Failure to follow this instruction may cause battery liquid leakage, electric shock, heat generation, smoke, fire, bursting, or other accident.

26. Do not directly connect the battery pack to the receptacle or a cigar lighter of an automobile.

• Failure to follow this instruction may cause battery liquid leakage, electric shock, heat generation, smoke, fire, bursting, or other accident.

27. Do not heat or highly pressurize the battery back by putting it in a microwave oven or high-pressure vessel.

• Failure to follow this instruction may cause battery liquid leakage, electric shock, heat generation, smoke, fire, bursting, or other accident.

28. Do not use the battery pack for other usages than use on the designated machine.

• Failure to follow this instruction may cause battery liquid leakage, electric shock, heat generation, smoke, fire, bursting, or other accident.

29. When taking out a battery pack, do not put a metal object such as clip, coin, key, screw, or nail close to the battery pack.

• Failure to follow this instruction may cause the battery pack to shortcircuit, possibly leading to an electric shock, smoke, fire, bursting, or other accident.

30. Do not short circuit the terminals of a battery pack.

• Carrying or storing a battery pack with a metal object such as a pin may cause short-circuiting, possibly leading to smoke, fire, bursting, or other accident.

31. Do not put the battery pack in fire.

• Failure to follow this instruction may cause the production of harmful substances, smoke, fire, bursting, and other accident.

32. Do not use a charger that has a broken power plug or cable, has been dropped, or has been damaged.

• Failure to follow this instruction may cause an electric shock, heat generation, smoke, fire, or other accident.

33. Do not use or charge this machine at a location with flammable liquid or gas.

• Failure to follow this instruction may cause smoke, fire, explosion, or other accident.

WARNING

Prohibition

34. Do not use or charge this machine in the rain or at a humid or wet location.

• Failure to follow this instruction may cause an electric shock, heat generation, smoke, fire, bursting, or other accident.

35. Do not touch the power plug with a wet hand.

• Failure to follow this instruction may cause an electric shock.

36. Do not use this machine when you are tired, drunk, or your ability to move and think is degraded due to treatment drugs or other factors.

• Failure to follow this instruction may cause a serious accident or injury.

37. Do not modify this machine. Do not disassemble or repair it by yourself.

• As this machine is compliant with the relevant safety standards, do not modify it.

• For repair, be sure to consult the store where you purchased this machine or us. Repair of this machine by yourself may lead to an accident or injury.

38. Do not use or store this machine at a location with a lot of dirt or dust.

• Entry of dust or the like in this machine may cause an accident such as heat generation, smoke, and fire.

39. Do not direct the tip of the riveter to yourself or another person.

• Failure to follow this instruction may lead to an injury when a rivet unexpectedly springs out.

40. Do not use this machine without attaching the mandrel collector (tank for used mandrel).

• Failure to follow this instruction may lead to an accident or injury when the mandrel of a rivet bursts out.

41. Do not rivet a rivet with a diameter other than the applicable rivet diameter.

• Failure to follow this instruction may cause an accident or injury.

42. Do not look into the hole of the nose piece or eject pipe.

• The mandrel of a cut rivet may spring out, possibly causing an injury.

43. When smoke is generated, do not inhale the smoke.

• Failure to follow this instruction may harm your body.

44. Do not cover the ventilation hole.

• Failure to follow this instruction may cause you to be burned or cause this machine to be abnormally heated, possibly leading to fire.

45. Do not allow the hot wind from the ventilation hole to directly blow to your skin.

• As the air becomes hot, you may get burned.

46. Do not touch a metal part immediately after work.

• As the air has become hot, you may get burned.

CAUTION

Compulsory

1. Carefully take care of the charger.

• Periodically inspect the power cable of the charger, and if it is damaged, request the store where you purchased this machine or us for repair.Failure to follow this instruction may cause an electric shock or short circuit.

• If you use an extension cord, periodically inspect it, and if it is damaged, replace it with a new one. Failure to follow this instruction may cause an electric shock or short circuit, possibly leading to fire.

2. If you do not use the charger, disconnect the power plug of the charger from the receptacle.

• This prevents accidents such as electric shock and fire.

3. Wipe dust and dirt accumulated on the power plug and receptacle with a dry cloth.

• This prevents accidents such as electric shock and fire.

4. When charging is not being carried out, remove the battery pack from the charger.

• This prevents accidents such as electric shock and fire.

5. When disconnecting the power plug, be sure to hold the power plug, not the cord.

• Disconnecting the power plug by holding the cord may cause an electric shock or short circuit.

6. Use an extension cord that suits the usage environment.

• When you charge the battery outdoors, use a cabtire code or an extension cord of cabtire cable.

7. Pay due attention during work.

• When you use a tool, carefully work while paying due attention to the handling method, work method, and the surrounding situation. An inconsiderate action may cause an accident or injury.

• Use common sense. Thoughtless action may lead to an accident or injury.

• Do not use this machine when you are tired. Failure to follow this instruction may cause an accident or injury.

CAUTION

Compulsory

8. Check whether there is any damaged part.

• Thoroughly check this machine before use for damage, and check whether this machine normally operates and performs its specific functions.

• Check the movable part for installation condition, parts for damage, and all the other components that affect operation for abnormality.

• If this machine cannot be started or stopped through the operation of the trigger switch, stop using this machine. Failure to follow this instruction may lead to an accident or injury when an abnormal action is made.

9. When you do not use this machine, adequately store it.

• Store this machine at a dry location that is at a height beyond the reach of children or can be locked with a key. Failure to follow this instruction may cause an accident or injury.

10. Always keep the work site clean and tidy.

• An untidy space or workbench may cause an accident.

11. While lightning is occurring, do not charge the battery, and disconnect the power plug from the receptacle.

• Failure to follow this instruction may lead to a failure, accident, or injury due to lightning strike.

12. Work with appropriate clothing.

• Cover long hair with a cap, hair covering, or the like, and do not wear loose clothes, accessories such as necklaces, and others. Failure to follow this instruction may cause you to be entangled by this machine, possibly leading to an injury.

13. At the time of the first use of this machine after its purchase, if a large amount of rust, damage, abnormal odor, abnormal heat generation, or other abnormality is observed, stop using the machine.

• Consult the store where you purchased this machine or us. Use of the battery in this condition may cause an accident or injury.

Prohibition

14. When you work at height, confirm that no one is beneath you.

• Failure to follow this instruction may lead to an accident due to the falling of material, this machine, or mandrel of a cut rivet.

15. When the machine body has become hot, suspend work, and after the machine body has cooled down, resume the work.

• Failure to follow this instruction may cause you to get burned.

16. Do not roughly handle the power cable of the charger.

• Do not carry the charger by holding the power cable or pull out the plug from the receptacle by pulling the power cable.

• Do not put the power cable close to heat, oil, or a sharp object.

• Carefully select the charging location so that the power cable is not treaded, hooked, or damaged due to an excessive force. Failure to follow this instruction may lead to an electric shock or fire due to a short circuit.

17. Do not store this machine at a location where the ambient temperature could rise to 50°C or higher (metallic box, automobile in summer, etc.).

• Such an environment may cause deterioration of the machine as well as an electric shock, heat generation, smoke, fire, bursting, or other accident.

18. Do not forcefully use this machine.

• To conduct work safely and efficiently, work at a speed that suits your ability. Use of this machine beyond your ability may cause an accident.

• Do not use this machine in a forceful manner that causes the motor to be locked. Failure to follow this instruction may cause heat generation, smoke, or fire.

19. Do not work in an unnatural posture.

• Always plant your feet on the ground and keep a balanced position. Failure to follow this instruction may cause you to fall, possibly leading to an accident or injury.

20. Do not operate this machine with its frame head dismantled.

• Failure to follow this instruction may cause your finger to be pinched, possibly leading to injury.

21. Do not scatter the mandrels of cut rivets.

• If mandrels are scattered, an accident or injury may occur.

22. Do not allow an LED light to directly irradiate your eyes.

• If an LED light continuously irradiates your eyes, your eyes may be damaged.

23. Do not put children close to this machine. Do not allow other persons than the worker to touch the tool, charger, and power cable.

• Failure to follow this instruction may cause a problem, accident, or injury.

24. Do not use this machine with unnecessary oil or other substances attached.

• Failure to follow this instruction may cause this machine to be dropped, possibly leading to an accident.

• Entry of oil or other substance in this machine may cause an electric shock, smoke, heat generation, fire, or bursting. Wipe off oil and other substances with a dry cloth or the like.